

part numbers KE-002, KE-004, KE-005

Adjusting tension on Kestrel Elite/Swift Focus assembly.

Kestrel Elite and Swift stands are provided with an adjusting wrench for focus assemblies. On the inside of the right knob is a plastic slotted adjustable sleeve, turning this sleeve clockwise will tighten and add tension to the focus assembly, turning clockwise with loosen, less tension.



If the focus knobs need to be tightened refer to *fig. 1* and if they need to be to have less tension refer to *fig. 2*.



fig. 1. Turn sleeve clockwise to tighten.

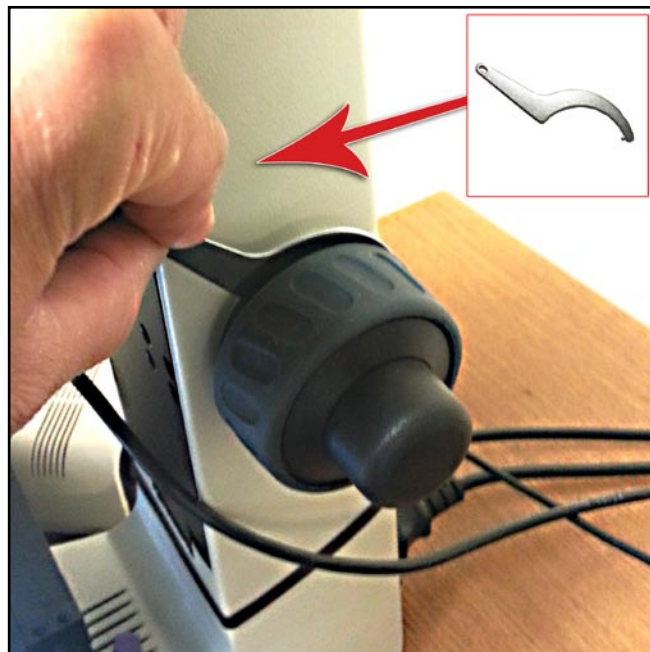

fig. 2. Turn sleeve counter clockwise to loosen

If assistance or more information is needed, please contact your Vision Engineering representative or please call the number listed below.
Thank You.